



## 특징 (Character)

- 취부용 밑면 고정핀 자리 2개소 기본가공  
Basic working 2-fixing pin positions at bottom for attachment
- JAW의 접촉부 몸체의 살두께 보강으로 내구성, 내마모성 향상  
Durability and wear resistance improvement by strengthen thickness of Jaw's contact body.
- 대상물의 중심기준 작업에 효과적  
Easy to grip the center of workpiece
- 마그네틱 센서 사용이 가능한 테이퍼 슬라이딩 방식의 그리퍼  
Taper Sliding type gripper which available to use magnetic sensor
- 롱 스트로크  
Long Stroke



## 테이퍼 슬라이딩 방식의 3JAW 방식 (Wedge type 3 jaw)

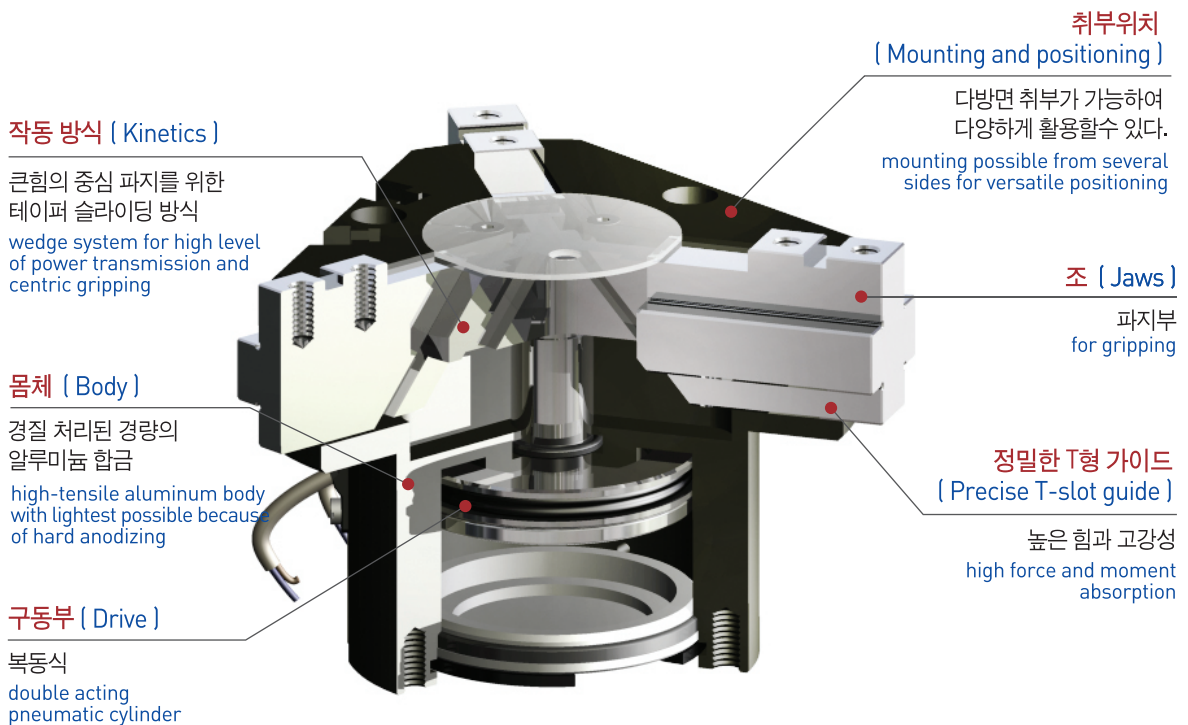

부품분해도 ( Exploded view )

※ 본 분해도는 한 제품을 예시하였으므로 기종별로 차이가 있을 수 있습니다.  
 ※ This is exploded view illustrates a certain product only. The contents may vary by product models.

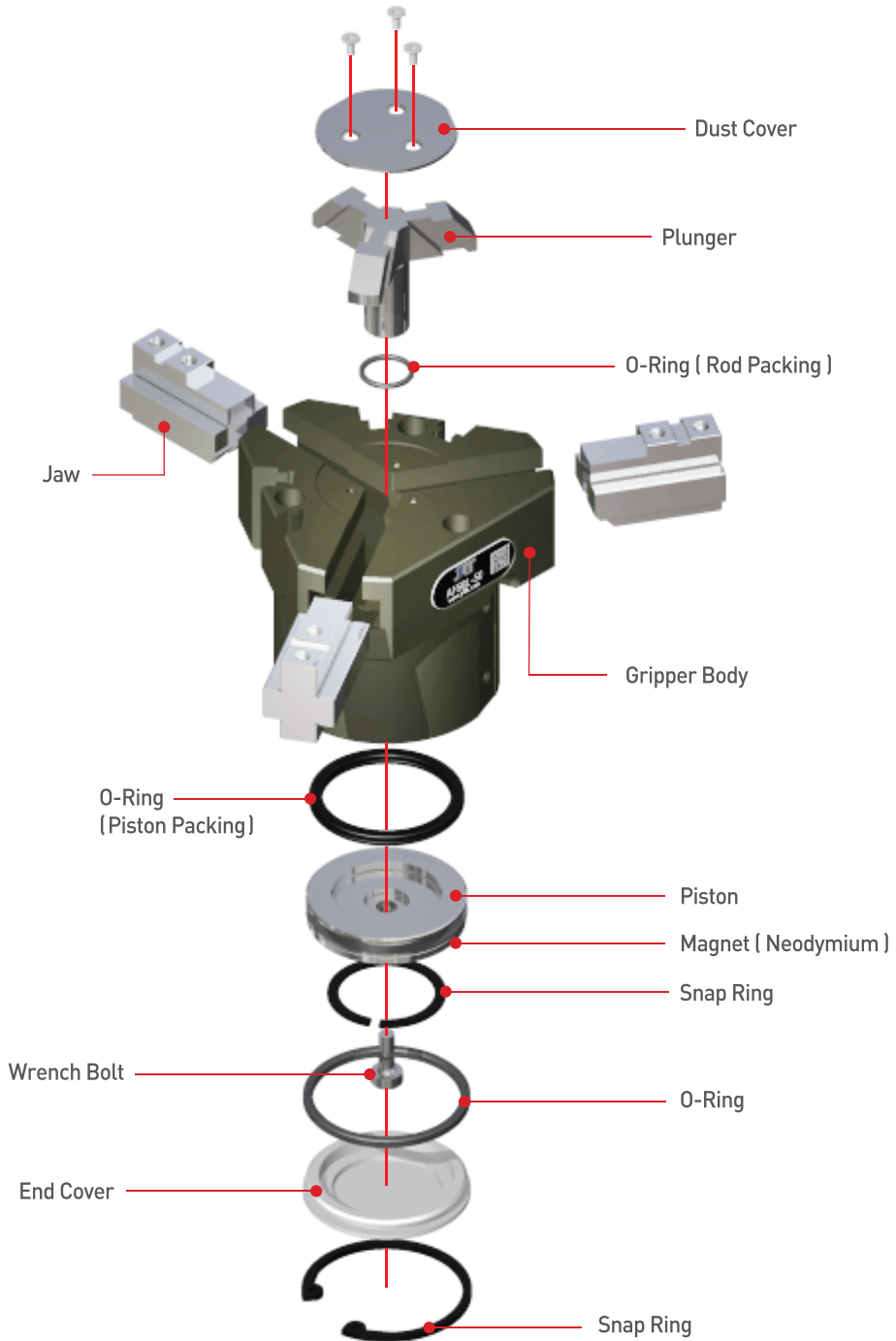

AF101
AF02
AF04P
AF105P
AF10
AF13
AF14
AF15
AF316
AF316L
AF416
AF17
AF117
AF24
AF26
AF28D
AF28DS
AF30 (SN)
AF30L
AF46 (SN)
<b>AF56L</b>
RAF56N
MF16

주문기호 ( How to Order )

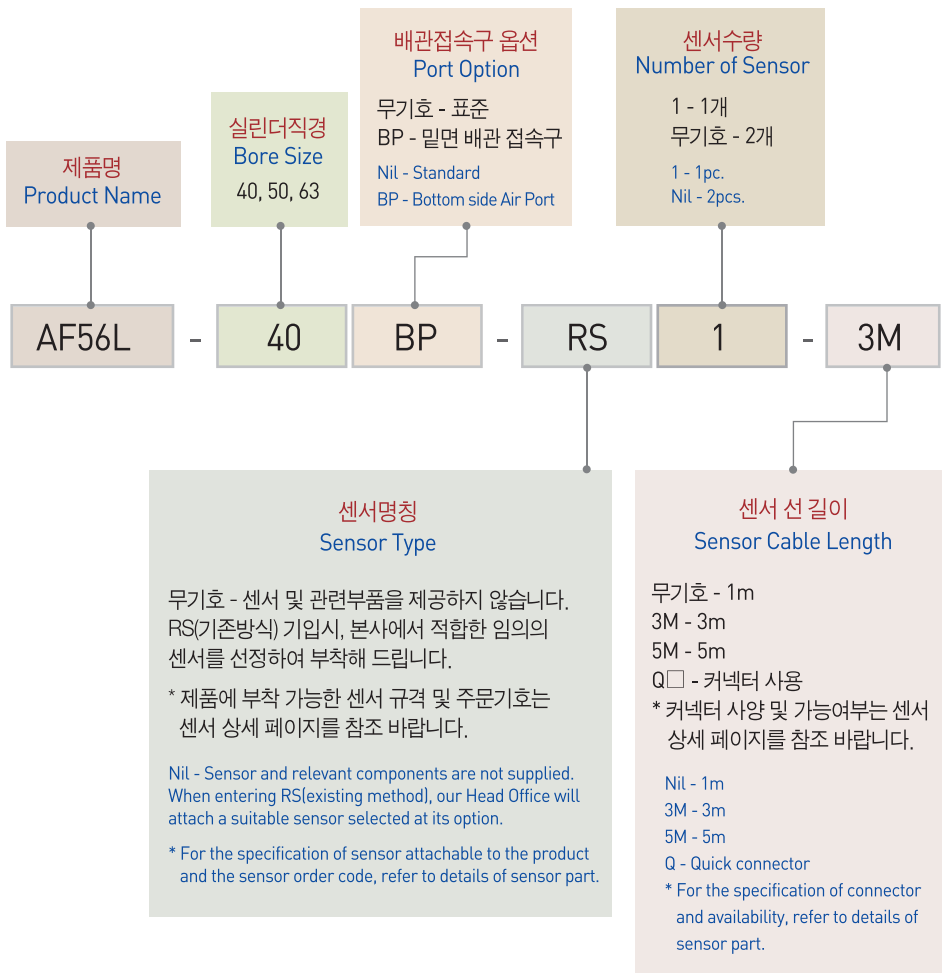
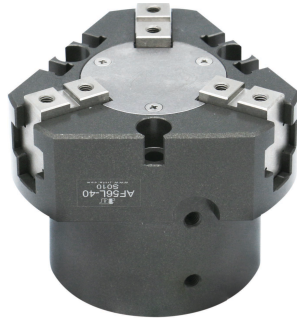

## ☐ 제품사양 ( Specification )

P=공기압력(bar), L=작용점까지의 거리(mm)  
P = Air Pressure(bar), L = Gripping point distance(mm)

제품명칭 Products Name	AF56L-40	AF56L-50	AF56L-63	단위 Unit
개폐범위 Stroke	22	30	34	mm
제품중량 Weight	0.7	1.2	1.9	kg
최대치구길이 Max. length attach	60	80	100	mm
배관접속구 Fitting size	M5	M5	PF(G) 1/8	
파지력 : 열림시 Gripping force : Open	103.99P / (1+0.007L)	150.09P / (1+0.007L)	238.38P / (1+0.006L)	N
파지력 : 닫힘시 Gripping force : Close	95.16P / (1+0.007L)	138.32P / (1+0.007L)	211.90P / (1+0.006L)	N
1사이클당 공기소모량 Air consumption per cycle	34	69	121	cm <sup>3</sup>
닫힘시/열림시 시간 Closing / Opening time	0.06 / 0.06	0.08 / 0.08	0.15 / 0.15	sec
반복정밀도 Repeat accuracy	0.02	0.02	0.02	mm
연속사용회수 Continuation usage amount	40	40	40	cpm
사용압력 Operating pressure	3~7			bar
주위온도 Ambient temperature	-5 to 60			°C
윤활 Lubrication	불필요 Needless			

반복정밀도 : 연속 100회 작동후 측정치  
After 100 consecutive strokes to end positions

## ☐ 작용점에서의 파지력 ( Gripping Force From a Point of Action )

범례( Legend ) : ■ 7[bar] ■ 5[bar] ■ 3[bar]

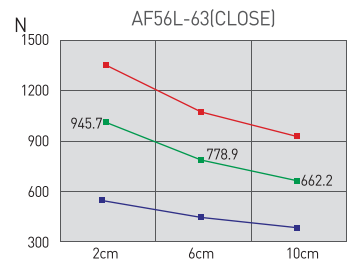
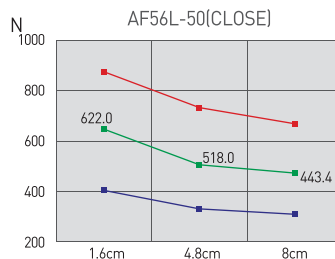
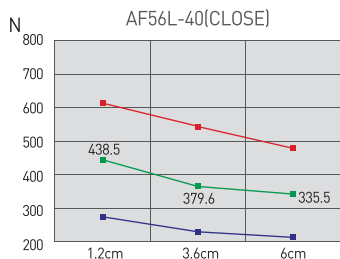
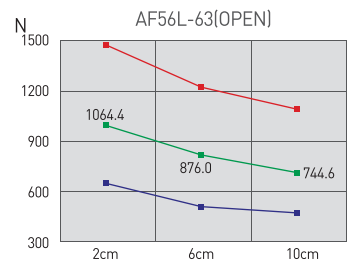
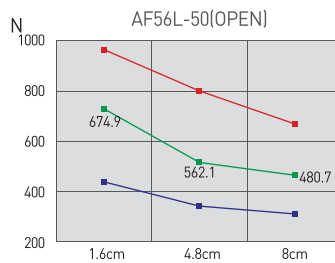
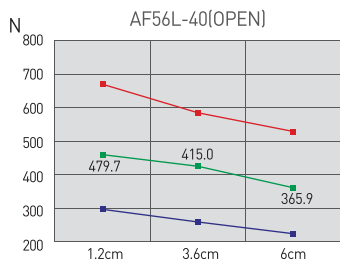

- AF101
- AF02
- AF04P
- AF105P
- AF10
- AF13
- AF14
- AF15
- AF316
- AF316L
- AF416
- AF17
- AF117
- AF24
- AF26
- AF28D
- AF28DS
- AF30 (SN)
- AF30L
- AF46 (SN)
- AF56L**
- RAF56N
- MF16

AF56L-40

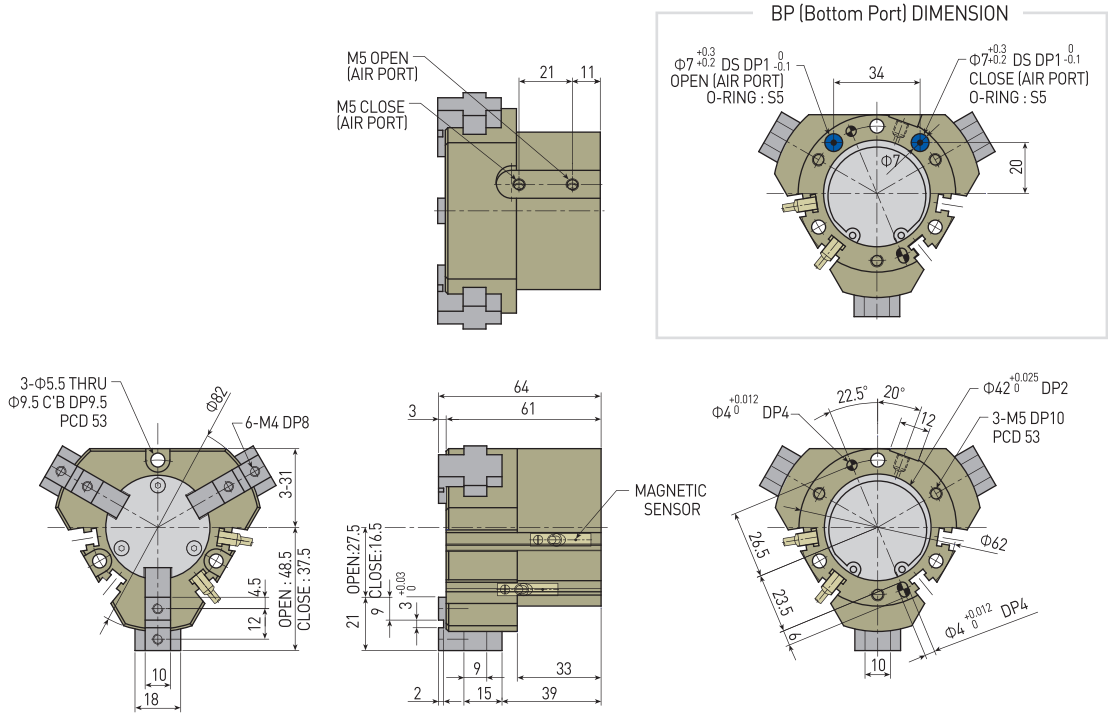

AF56L-50

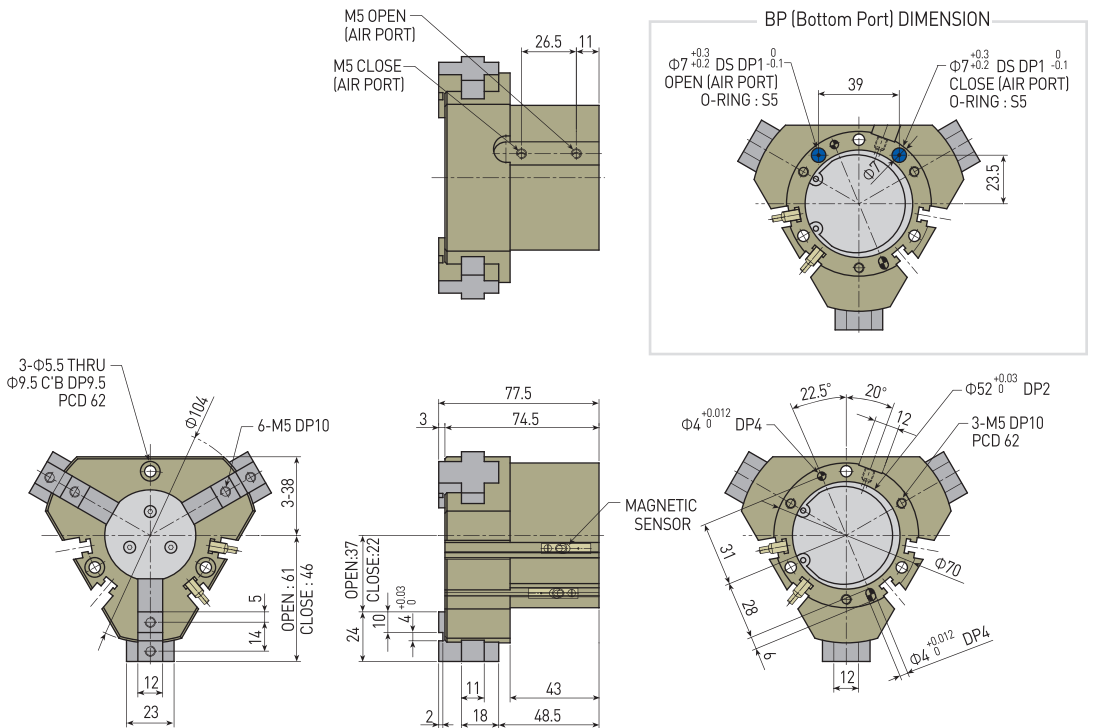

AF56L-63

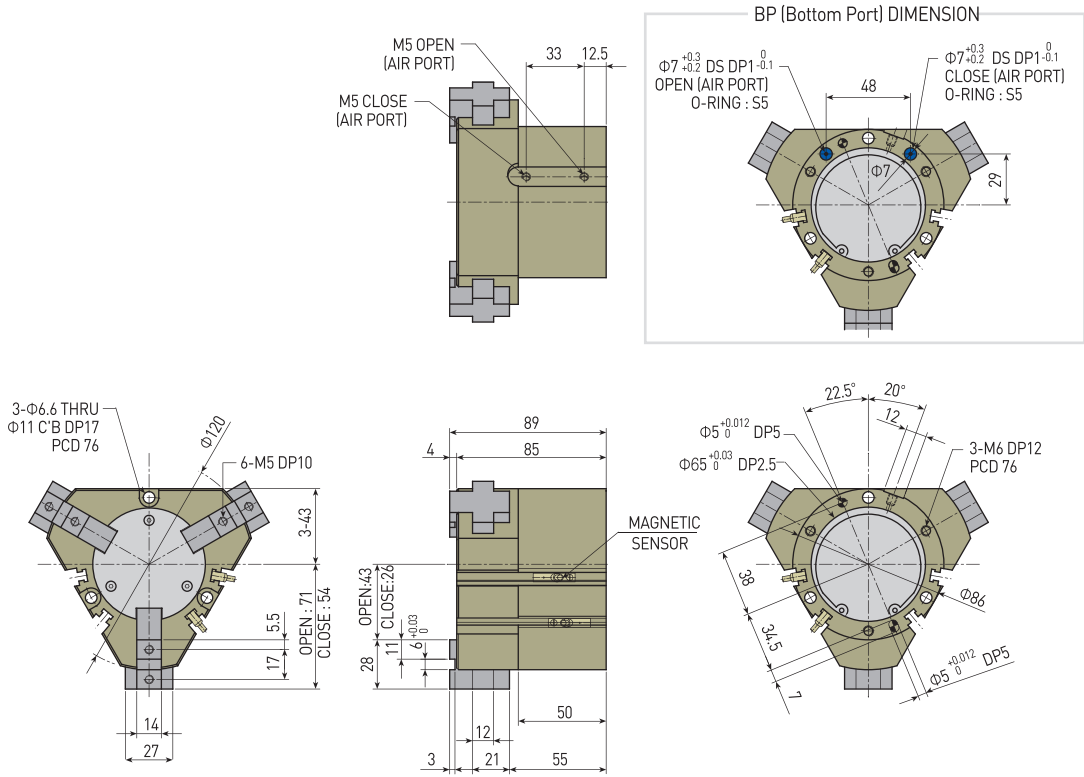

AF101

AF02

AF04P

AF105P

AF10

AF13

AF14

AF15

AF316

AF316L

AF416

AF17

AF117

AF24

AF26

AF28D

AF28DS

AF30 (SN)

AF30L

AF46 (SN)

AF56L

RAF56N

MF16