

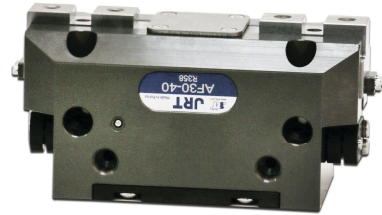

특징 (Character)

- 테이퍼 슬라이딩 방식에 의한 견고한 면압구동방식
Surface pressure driving type by taper sliding
- COMPACT한 구조와 다양한 취부 편의성
Compact structure and various mounting convenience
- 배면포트를 이용(BP 옵션)하면 MODULE 구성시 AIR 배관에서 TUBE를 생략할 수 있어 공간절약 및 편리성의 추가가 가능
Possible to use without the supply tube when you use back side support port(BP option)
- 근접스위치만 부착 가능합니다.
Proximity sensor is available for open-close sensing.



웨이 방식 (Wedge type)

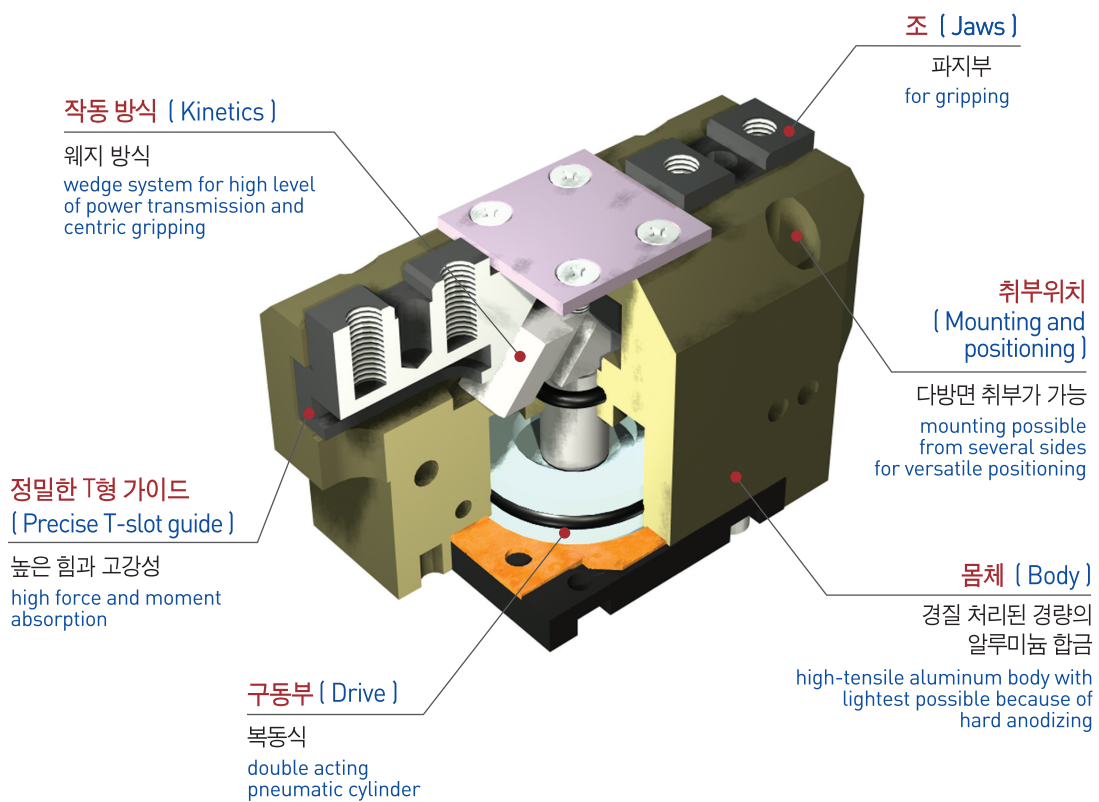

AF101

AF02

AF04P

AF105P

AF10

AF13

AF14

AF15

AF316

AF316L

AF416

AF17

AF117

AF24

AF26

AF28D

AF28DS

AF30(SN)

AF30L

AF46(SN)

AF56L

RAF56N

MF16

부품분해도 (Exploded view)

※ 본 분해도는 한 제품을 예시하였으므로 기종별로 차이가 있을 수 있습니다.
 ※ This is exploded view illustrates a certain product only. The contents may vary by product models.

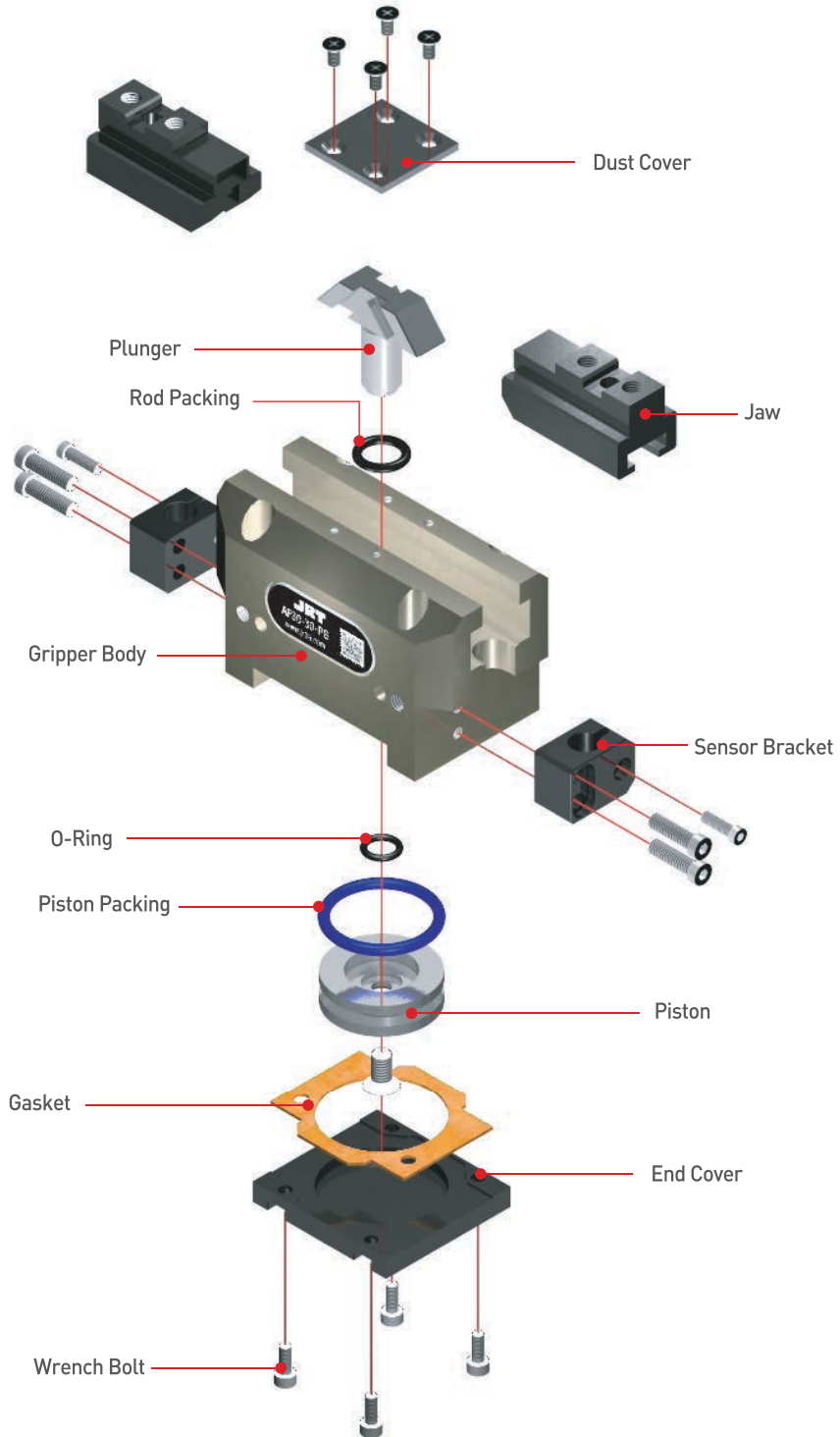

주문기호 (How to Order)

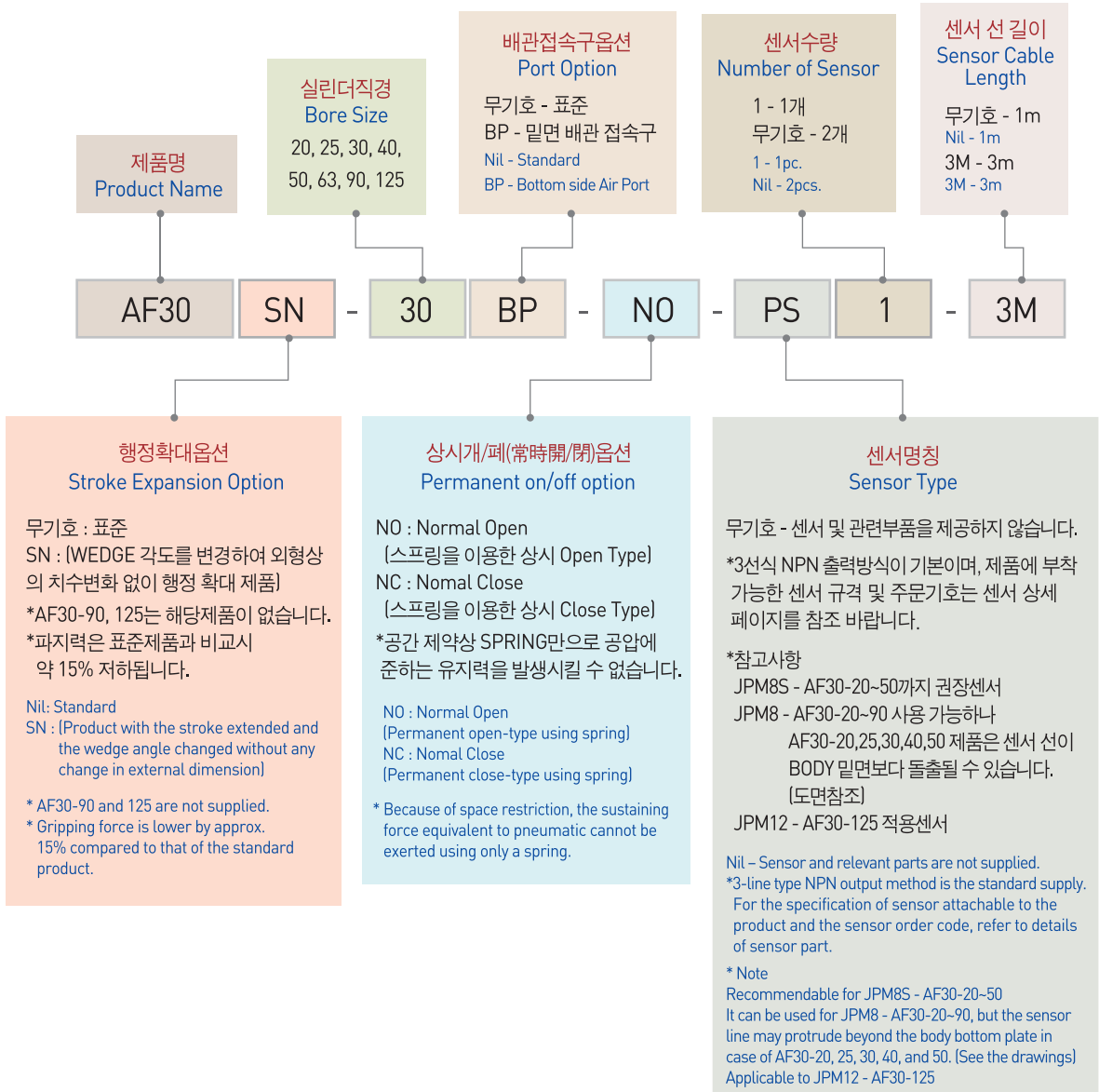

AF30L 주문기호 (AF30L How to Order)

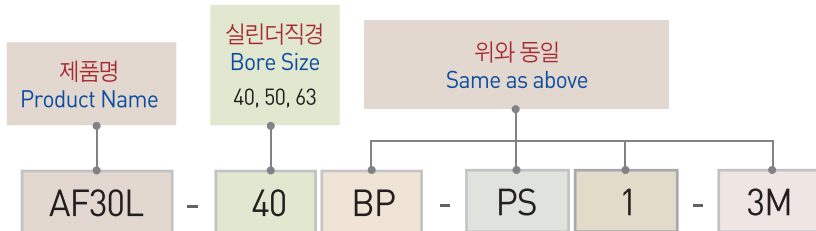

※ AF30 type의 취부호환성과 파지력을 유지하며 개폐범위를 획기적으로 증대시킨 제품입니다.
It is interfaced with AF30 type and maintains the same gripping force, but significantly increases its stroke.

- AF101
- AF02
- AF04P
- AF105P
- AF10
- AF13
- AF14
- AF15
- AF316
- AF316L
- AF416
- AF17
- AF117
- AF24
- AF26
- AF28D
- AF28DS
- AF30(SN)**
- AF30L
- AF46(SN)
- AF56L
- RAF56N
- MF16

☐ 제품사양 (Specification)

P=공기압력(bar), L=작용점까지의 거리(mm)
P = Air Pressure(bar), L = Gripping point distance(mm)

제품명칭 Products Name	AF30-20		AF30-25		AF30-30		AF30-40			단위 Unit
	Standard	AF30SN-20	Standard	AF30SN-25	Standard	AF30SN-30	Standard	AF30SN-40	AF30L-40	
개폐범위 Stroke	8	10	12	16	16	20	20	26	40	mm
제품중량 Weight	0.14		0.3		0.47		0.81		1.4	kg
최대치구길이 Max. length attach	50		60		77		100			mm
배관접속구 Fitting size	M5		M5		M5		PF(G) 1/8			
파지력 : 열림시 Gripping force : Open	28.45P 1+0.016L	25.32P 1+0.016L	43.16P 1+0.012L	37.86P 1+0.012L	62.78P 1+0.009L	54.88P 1+0.009L	112.82P 1+0.007L	98.64P 1+0.007L	112.82P 1+0.007L	N
파지력 : 닫힘시 Gripping force : Close	25.51P 1+0.016L	22.70P 1+0.016L	39.24P 1+0.012L	34.38P 1+0.012L	55.92P 1+0.009L	48.90P 1+0.009L	99.08P 1+0.007L	86.64P 1+0.007L	99.08P 1+0.007L	N
1사이클당 공기소모량 Air consumption per cycle	3.5		7.0		13.4		30.7		58	cm ³
닫힘시/열림시 시간 Closing / Opening time	0.01/0.01		0.01/0.01		0.02/0.02		0.04/0.04		0.06/0.06	sec
반복정밀도 Repeat accuracy	0.01		0.01		0.01		0.02		0.02	mm
연속사용회수 Continuation usage amount	60		60		50		50		40	cpm
사용압력 Operating pressure	3~7									bar
주위온도 Ambient temperature	-5 to 60									°C
윤활 Lubrication	불필요 Needless									

제품명칭 Products Name	AF30-50			AF30-63			AF30-90	AF30-125	단위 Unit	
	Standard	AF30SN-50	AF30L-50	Standard	AF30SN-63	AF30L-63				
개폐범위 Stroke	26	32	46	32	38	52	50	70	mm	
제품중량 Weight	1.37		2.3	2.6		3.8	4.8	13.9	kg	
최대치구길이 Max. length attach	127			160			200	240	mm	
배관접속구 Fitting size	PF(G) 1/8			PF(G) 1/8			PF(G) 1/8	PF(G) 1/4		
파지력 : 열림시 Gripping force : Open	179.52P 1+0.006L	156.61P 1+0.006L	179.52P 1+0.006L	288.41P 1+0.005L	250.98P 1+0.005L	288.41P 1+0.005L	464.99P / (1+0.004L)	848.57P / (1+0.003L)	N	
파지력 : 닫힘시 Gripping force : Close	160.88P 1+0.006L	140.33P 1+0.006L	160.88P 1+0.006L	258.98P 1+0.005L	232.88P 1+0.005L	258.98P 1+0.005L	435.56P / (1+0.004L)	830.91P / (1+0.003L)	N	
1사이클당 공기소모량 Air consumption per cycle	59.6		113	118.4		199	305.8	978.6	cm ³	
닫힘시/열림시 시간 Closing / Opening time	0.06/0.06		0.08/0.08	0.12/0.12		0.14/0.14	0.3/0.3	1.0/1.0	sec	
반복정밀도 Repeat accuracy	0.02			0.02			0.02	0.02	mm	
연속사용회수 Continuation usage amount	40	30		40	30		30	20	cpm	
사용압력 Operating pressure	3~7									bar
주위온도 Ambient temperature	-5 to 60									°C
윤활 Lubrication	불필요 Needless									

반복정밀도 : 연속 100회 작동후 측정치
After 100 consecutive strokes to end positions

작용점에서의 파지력 (Gripping Force From a Point of Action)

범례(Legend) : ■ 7[bar] ■ 5[bar] ■ 3[bar]

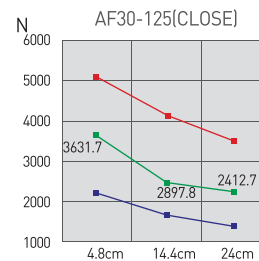
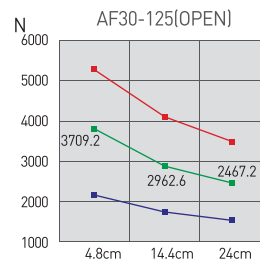
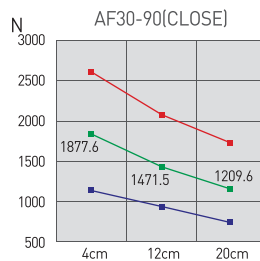
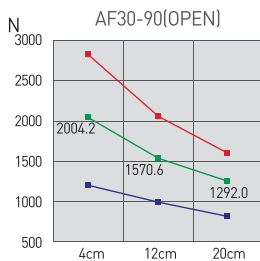
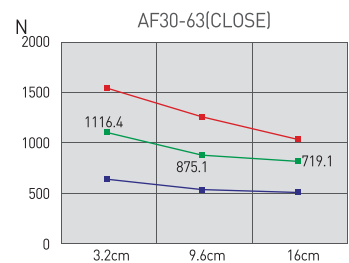
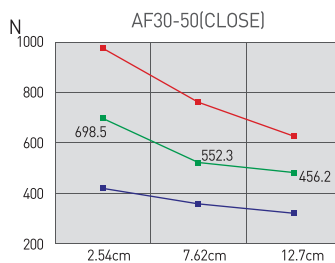
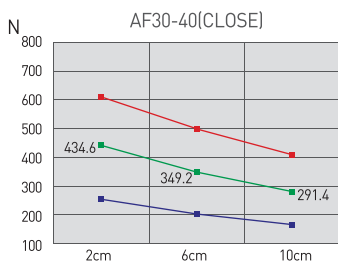
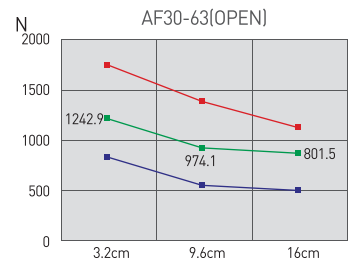
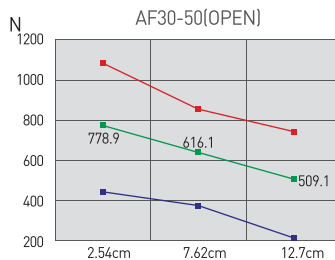
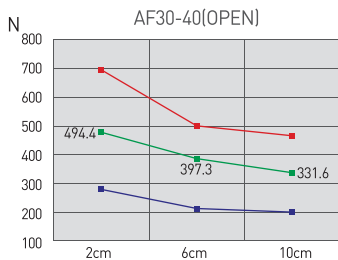
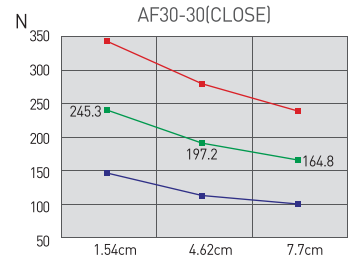
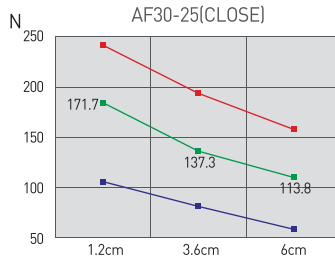
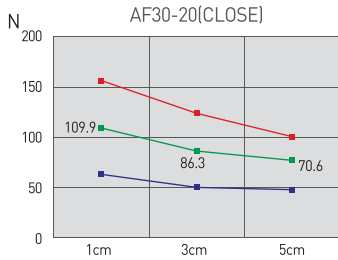
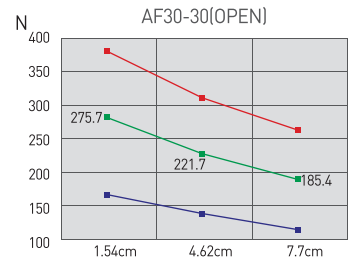
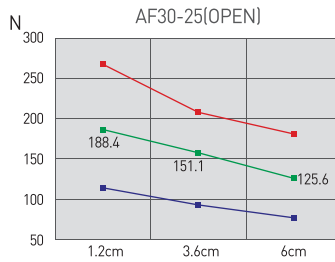
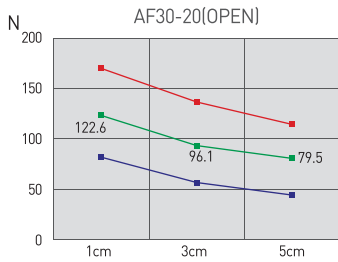

- AF101
- AF02
- AF04P
- AF105P
- AF10
- AF13
- AF14
- AF15
- AF316
- AF316L
- AF416
- AF17
- AF117
- AF24
- AF26
- AF28D
- AF28DS
- AF30(SN)
- AF30L
- AF46(SN)
- AF56L
- RAF56N
- MF16

AF30-20

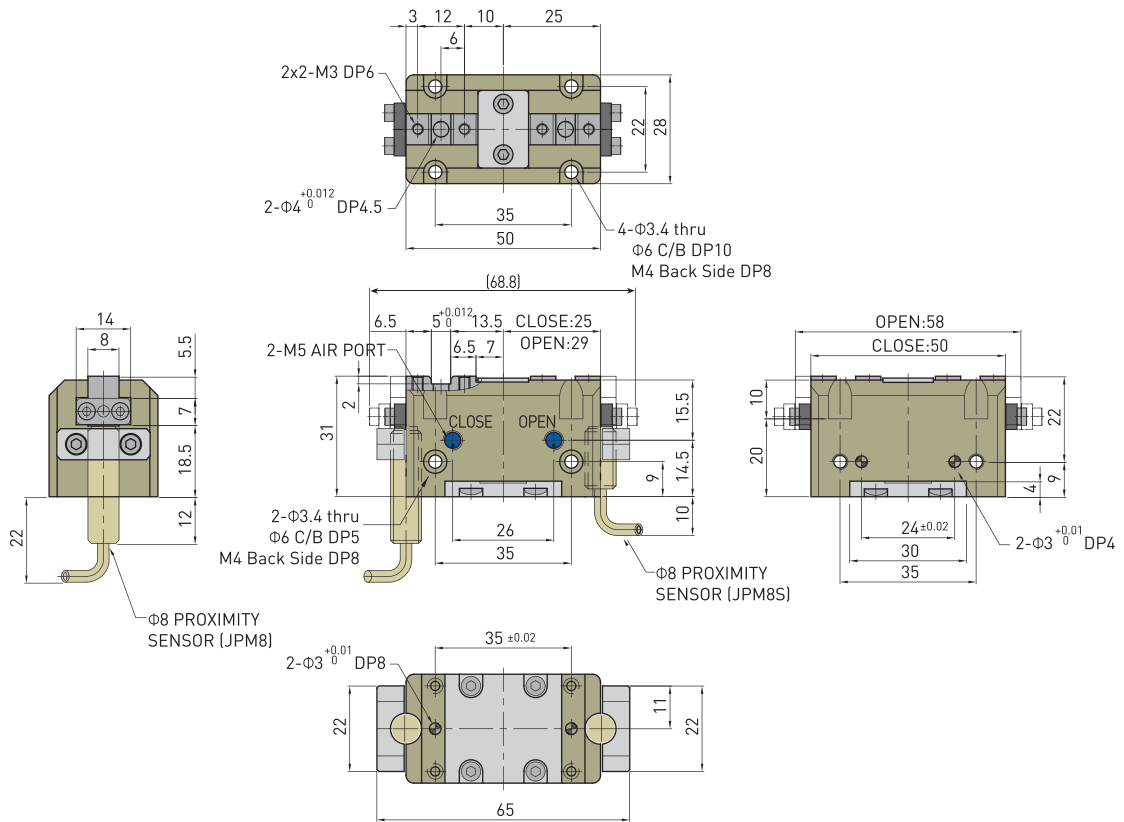

- AF30-20 BP (밀면 포트 옵션)
BP(Bottom Port) AF30-20 BP

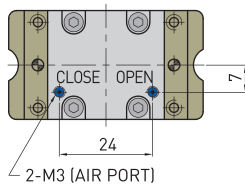

- AF30-20 NO/NC(상시 개폐 옵션)
AF30-20 NO/NC(NORMAL OPEN / NORMAL CLOSE)

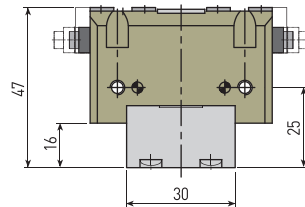

- AF30SN-20 (행정확대제품)
AF30SN-20 (Stroke extended product)

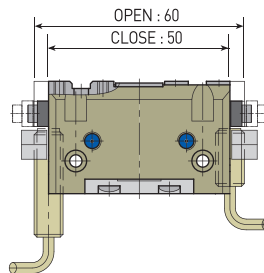

AF30-25

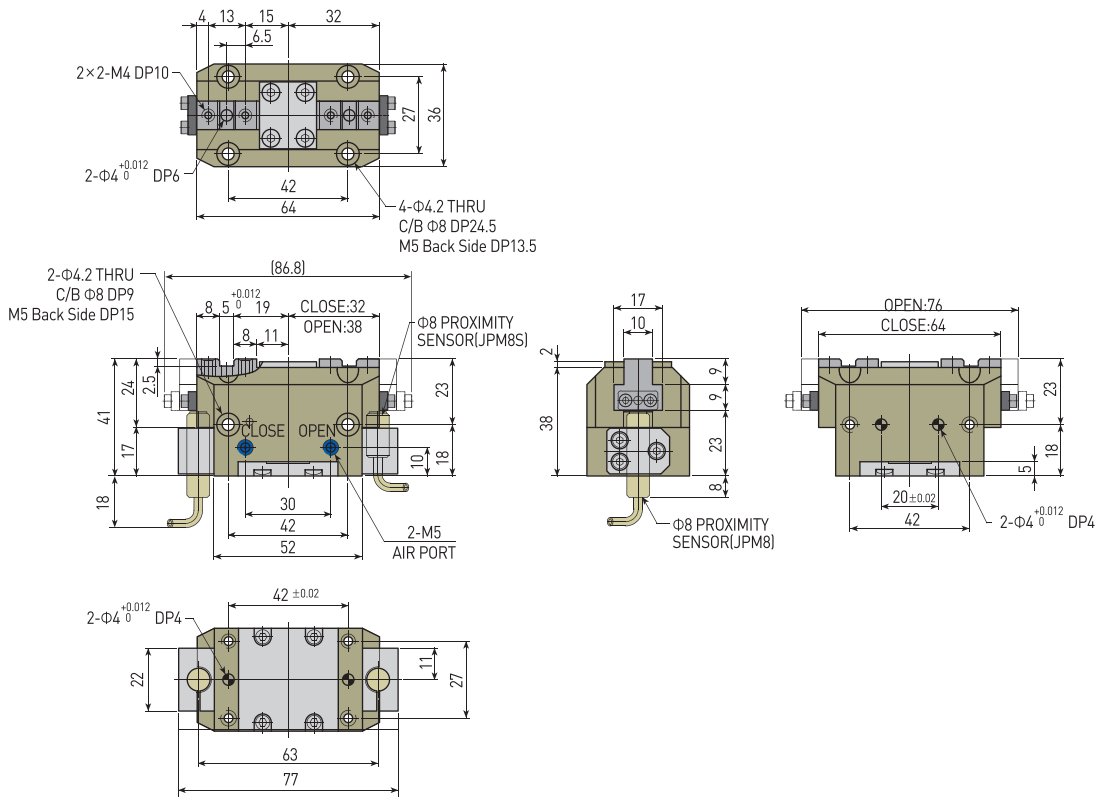

- AF30-25 BP (밀면 포트 옵션)
BP(Bottom Port) AF30-25 BP

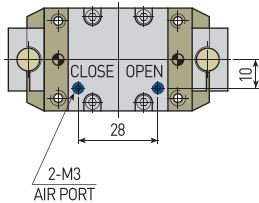

- AF30-25 NO / NC(상시 개, 폐 옵션)
AF30-25 NO / NC(NORMAL OPEN / NORMAL CLOSE)

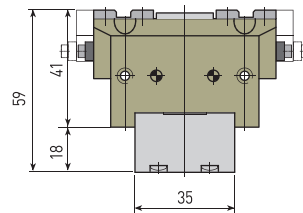

- AF30SN-25 (행정확대제품)
AF30SN-25 (Stroke extended product)

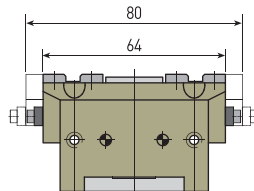

AF101
AF02
AF04P
AF105P
AF10
AF13
AF14
AF15
AF316
AF316L
AF416
AF17
AF117
AF24
AF26
AF28D
AF28DS
AF30(SN)
AF30L
AF46(SN)
AF56L
RAF56N
MF16

AF30-30

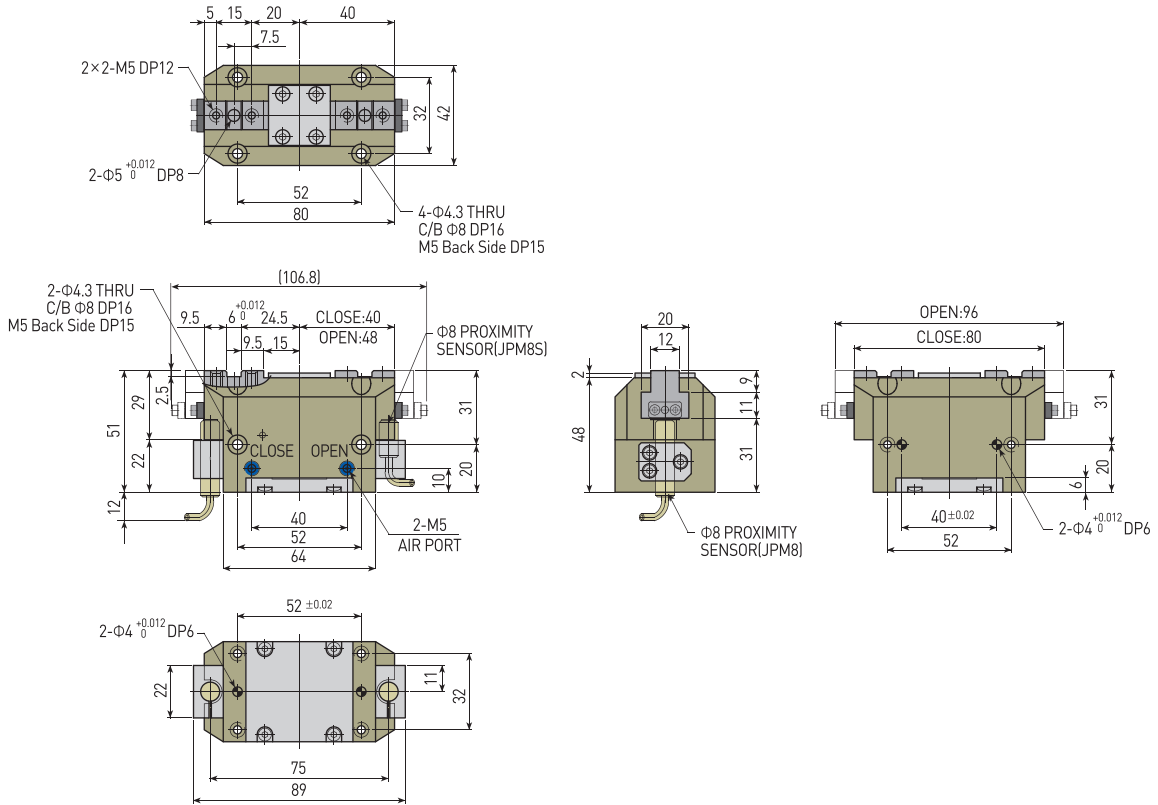

- AF30-30 BP (밑면 포트 옵션)
BP(Bottom Port) AF30-30 BP

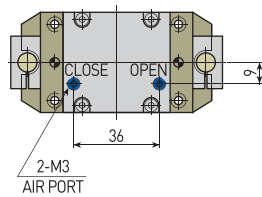

- AF30-30 NO / NC(상시 개폐 옵션)
AF30-30 NO / NC (NORMAL OPEN / NORMAL CLOSE)

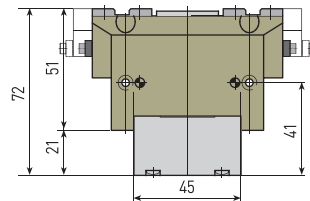

- AF30SN-30 (행정확대제품)
AF30SN-30 (Stroke extended product)

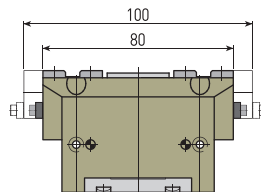

AF30-40

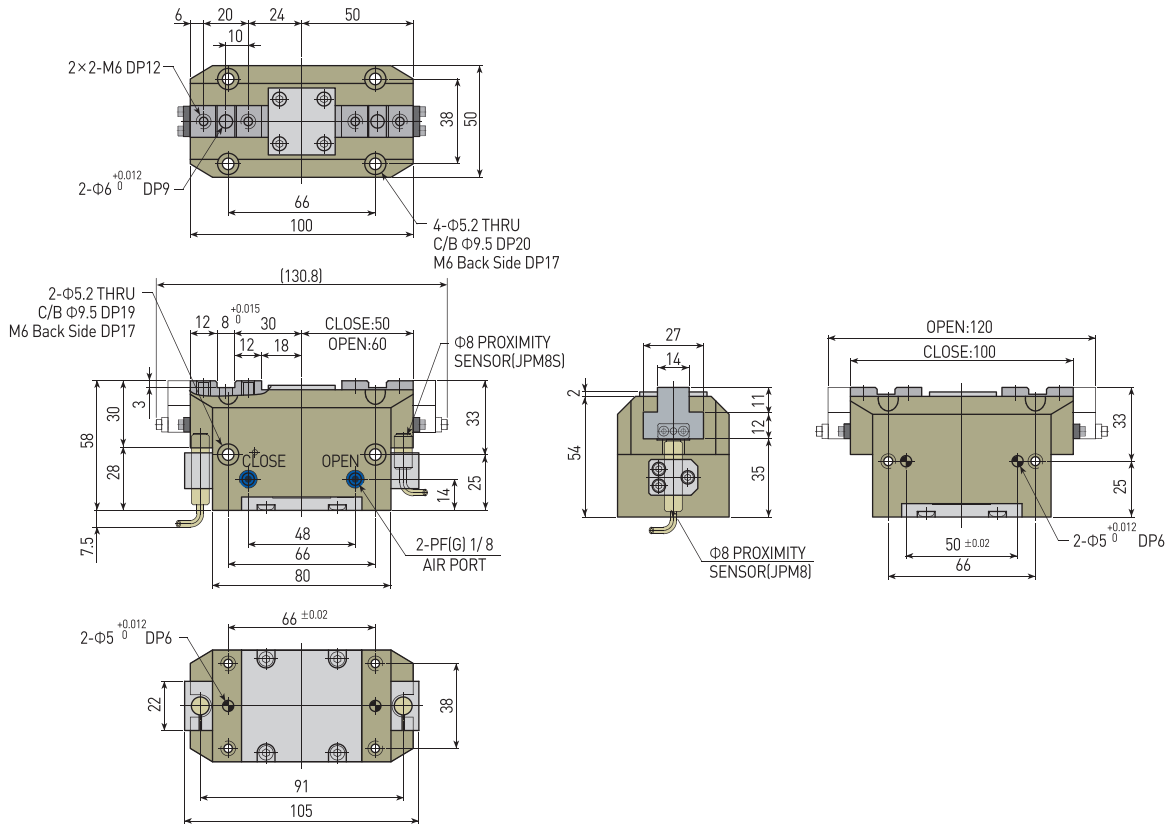

- AF30-40 BP(밑면 포트 옵션)
BP(Bottom Port) AF30-40 BP

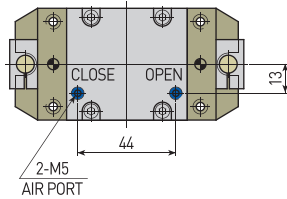

- AF30-40 NO / NC(상시 개,폐 옵션)
AF30-40 NO / NC(NORMAL OPEN / NORMAL CLOSE)

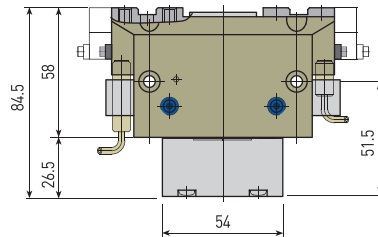

- AF30SN-40 (행정 확대 제품)
AF30SN-40 (Stroke extended product)

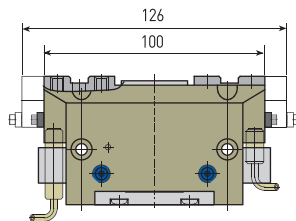

AF101
AF02
AF04P
AF105P
AF10
AF13
AF14
AF15
AF316
AF316L
AF416
AF17
AF117
AF24
AF26
AF28D
AF28DS
AF30(SN)
AF30L
AF46(SN)
AF56L
RAF56N
MF16

AF30-50

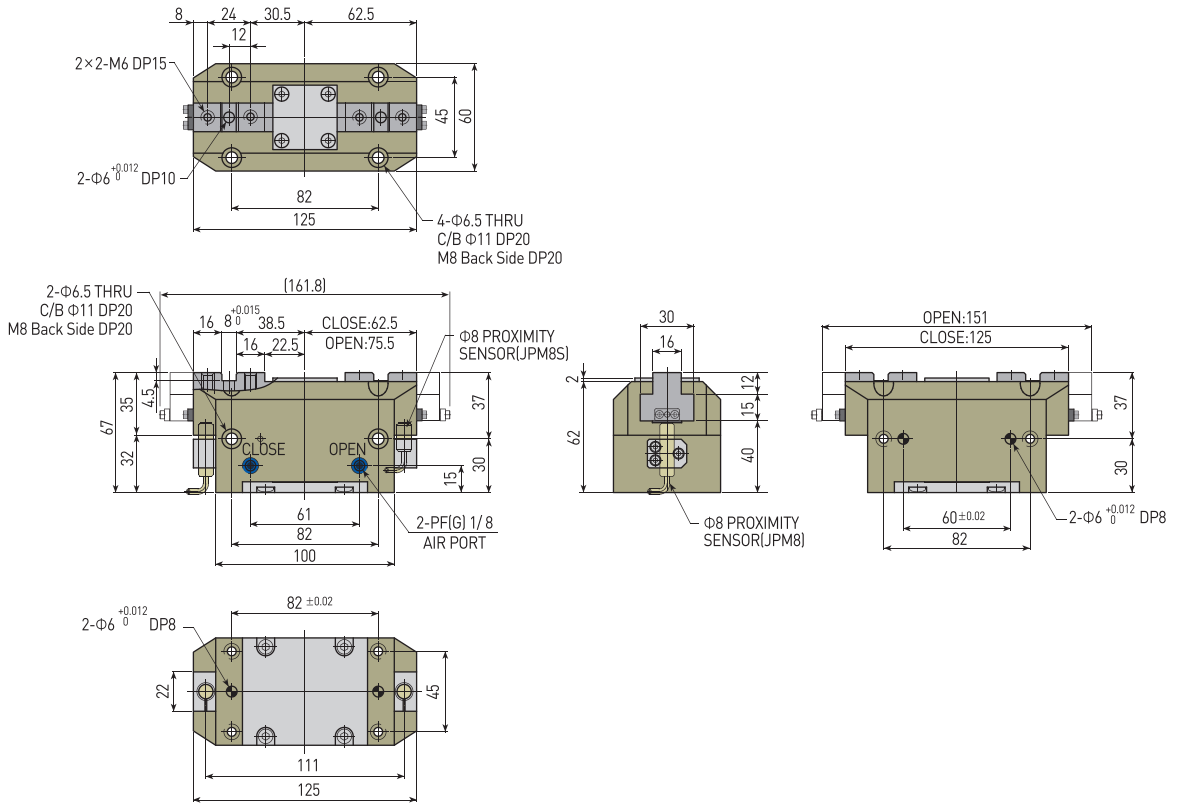

- AF30-50 BP (밑면 포트 옵션)
BP(Bottom Port) AF30-50 BP

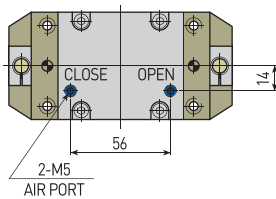

- AF30-50 NO / NC(상시 개폐 옵션)
AF30-50 NO / NC(NORMAL OPEN / NORMAL CLOSE)

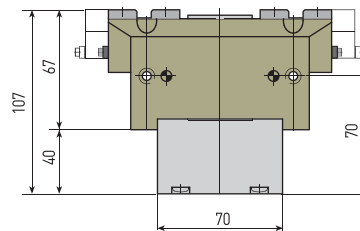

- AF30SN-50 (행정 확대 제품)
AF30SN-50 (Stroke extended product)

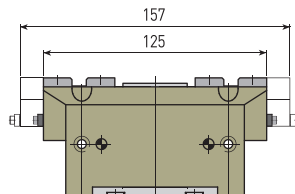

AF30-63

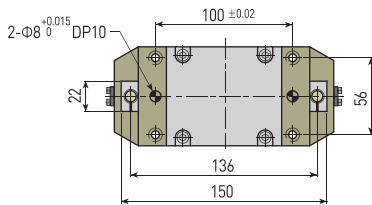
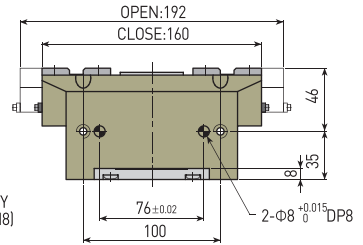
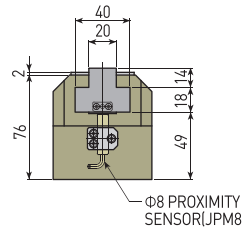
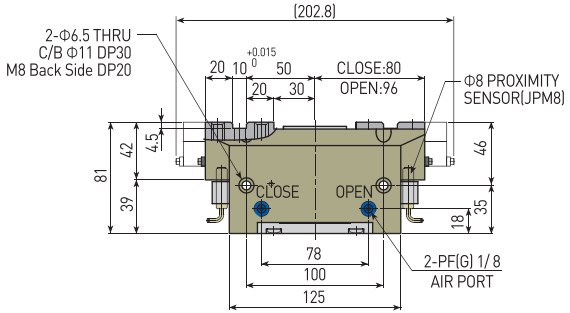
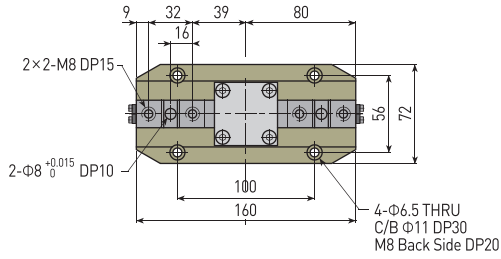

- AF30-63 BP[밀면 포트 옵션]
BP(Bottom Port) AF30-63 BP

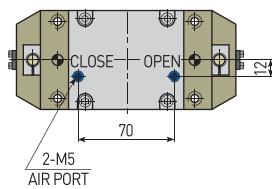

- AF30-63 NO / NC(상시 개폐 제품)
AF30-63 NO / NC(NORMAL OPEN / NORMAL CLOSE)

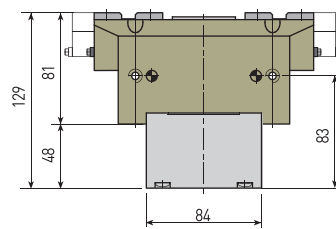

- AF30SN-63 (행정 확대 제품)
AF30SN-63 (Stroke extended product)

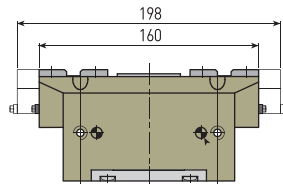

AF101
AF02
AF04P
AF105P
AF10
AF13
AF14
AF15
AF316
AF316L
AF416
AF17
AF117
AF24
AF26
AF28D
AF28DS
AF30(SN)
AF30L
AF46(SN)
AF56L
RAF56N
MF16

AF30-90

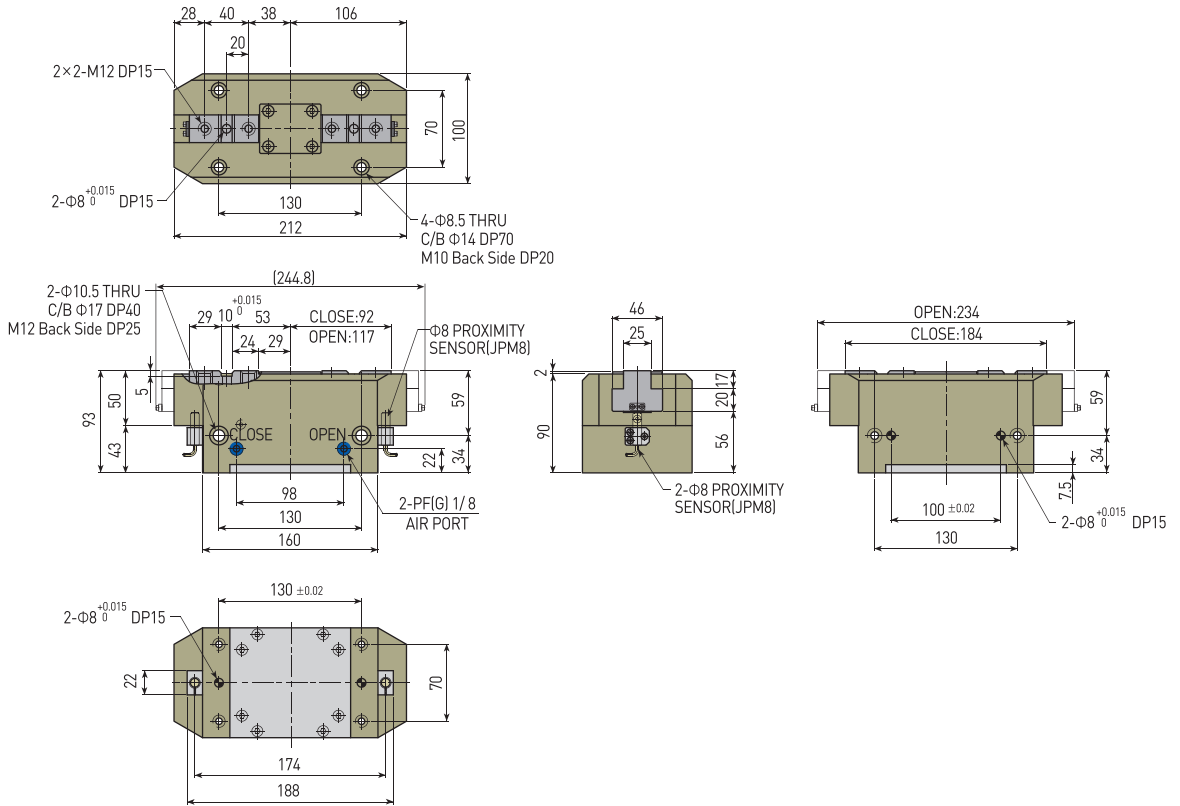

- AF30-90 BP(밀면 포트 옵션)
BP(Bottom Port) AF30-90 BP

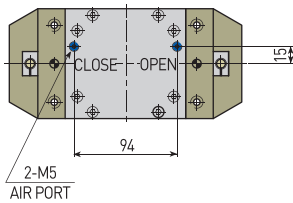

- AF30-90 NO / NC(상시 개폐 제품)
AF30-90 NO / NC(NORMAL OPEN / NORMAL CLOSE)

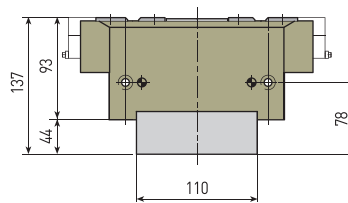

AF30-125

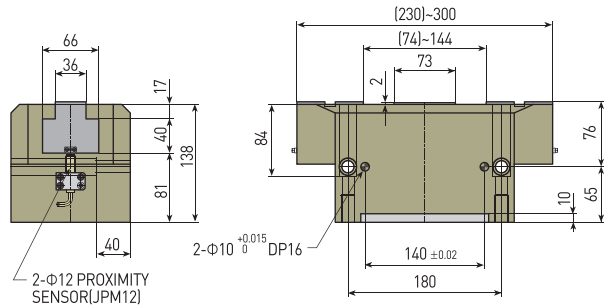
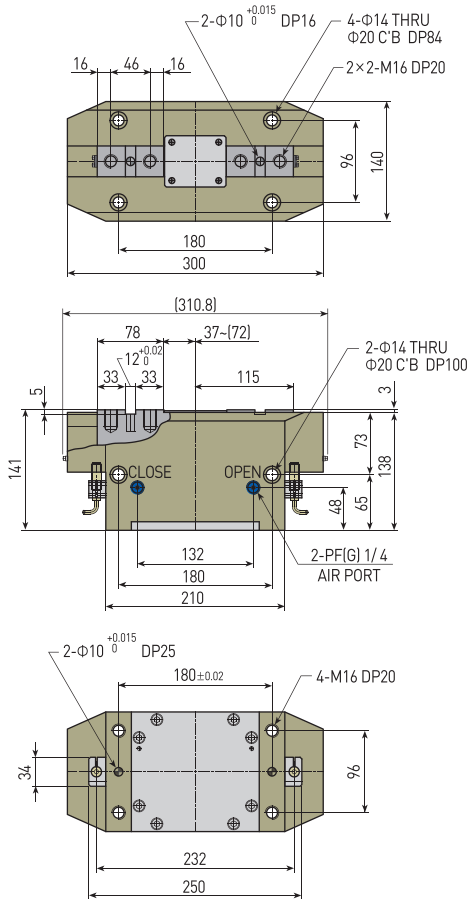

- AF30-125 BP(밑면 포트 옵션)
BP(Bottom Port) AF30-125 BP

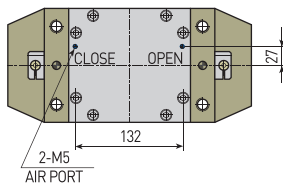

- AF30-125 NO/NC(상시 개/폐 제품)
AF30-125 NO / NC(NORMAL OPEN / NORMAL CLOSE)

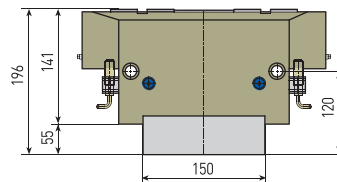

AF101

AF02

AF04P

AF105P

AF10

AF13

AF14

AF15

AF316

AF316L

AF416

AF17

AF117

AF24

AF26

AF28D

AF28DS

AF30(SN)

AF30L

AF46(SN)

AF56L

RAF56N

MF16